

PHASING LEGEND

- PHASE 1
532 UNITS
- PHASE 2
794 UNITS
- PHASE 3
874 UNITS
- TOTAL
2,200 UNITS

THE PHASING PLAN IS CONCEPTUAL IN LOCATION AND SIZE OF PROPOSED FACILITIES AND MAY BE ADJUSTED TO RESPOND TO MARKET CONDITIONS, INFRASTRUCTURE PHASING OR OTHER SITE CONDITIONS.

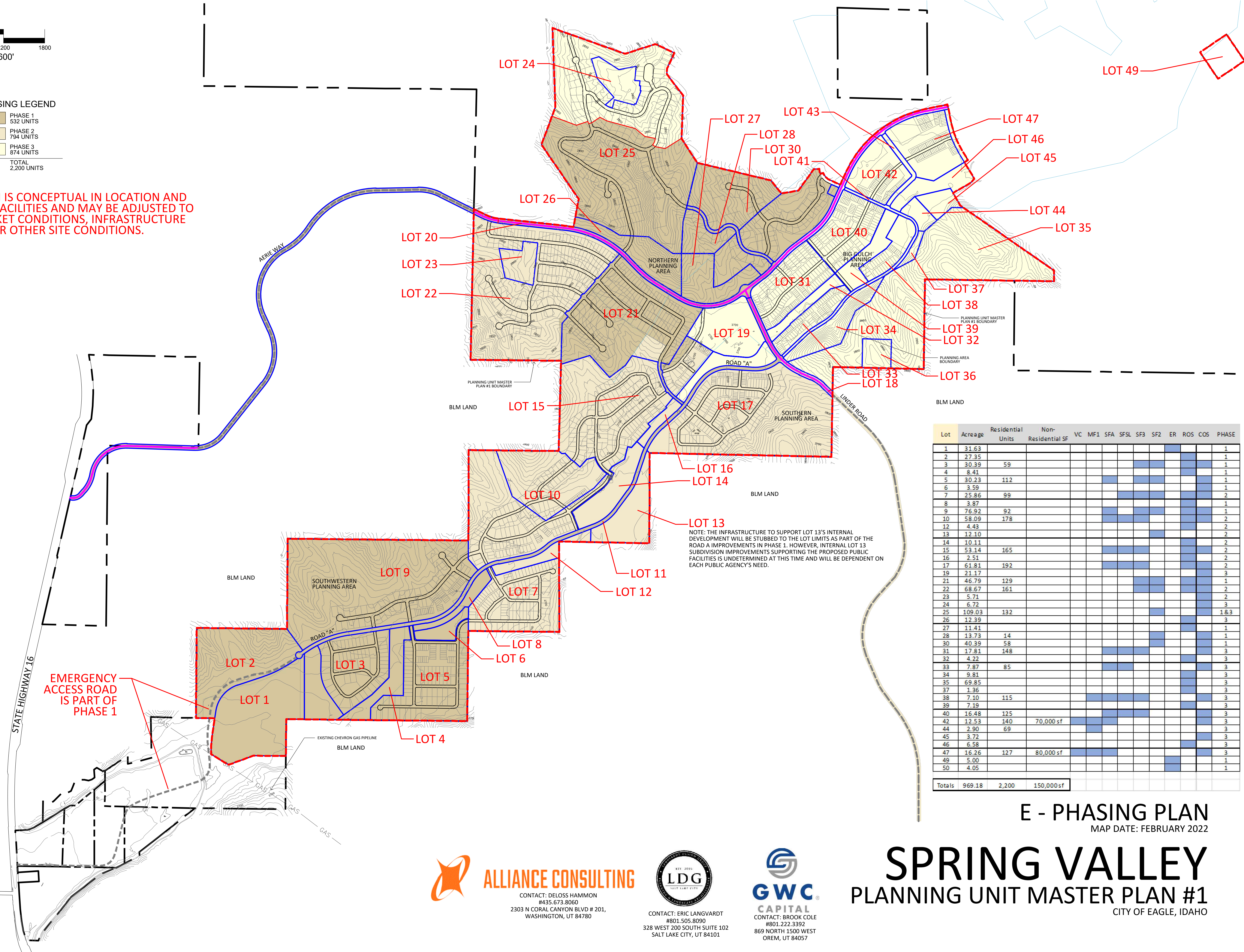

Lot	Acreage	Residential Units	Non-Residential SF	VC	MF1	SFA	SFSL	SF3	SF2	ER	ROS	COS	PHASE
1	31.63												1
2	27.35												1
3	30.39	59											1
4	8.41												1
5	30.23	112											1
6	3.59												1
7	25.86	99											2
8	3.87												1
9	76.92	92											1
10	58.09	178											2
12	4.43												2
13	12.10												2
14	10.11												2
15	53.14	165											2
16	2.51												2
17	61.81	192											2
19	21.17												3
21	46.79	129											1
22	68.67	161											2
23	5.71												2
24	6.72												3
25	109.03	132											1,8,3
26	12.39												3
27	11.41												1
28	13.73	14											1
30	40.39	58											1
31	17.81	148											3
32	4.22												3
33	7.87	85											3
34	9.81												3
35	69.85												3
37	1.36												3
38	7.10	115											3
39	7.19												3
40	16.48	125											3
42	12.53	140	70,000 sf										3
44	2.90	69											3
45	3.72												3
46	6.58												3
47	16.26	127	80,000 sf										3
49	5.00												1
50	4.05												1
Totals	969.18	2,200	150,000 sf										

LOT 13
NOTE: THE INFRASTRUCTURE TO SUPPORT LOT 13'S INTERNAL DEVELOPMENT WILL BE STUBBED TO THE LOT LIMITS AS PART OF THE ROAD A IMPROVEMENTS IN PHASE 1. HOWEVER, INTERNAL LOT 13 SUBDIVISION IMPROVEMENTS SUPPORTING THE PROPOSED PUBLIC FACILITIES IS UNDETERMINED AT THIS TIME AND WILL BE DEPENDENT ON EACH PUBLIC AGENCY'S NEED.

EMERGENCY ACCESS ROAD IS PART OF PHASE 1

E - PHASING PLAN
MAP DATE: FEBRUARY 2022

SPRING VALLEY
PLANNING UNIT MASTER PLAN #1
CITY OF EAGLE, IDAHO

ALLIANCE CONSULTING
CONTACT: DELOSS HAMMON
#435.673.8060
2303 N CORAL CANYON BLVD # 201,
WASHINGTON, UT 84780

LDG
CONTACT: ERIC LANGVARDT
#801.505.8090
328 WEST 200 SOUTH SUITE 102
SALT LAKE CITY, UT 84101

GWC
CAPITAL
CONTACT: BROOK COLE
#801.222.3392
869 NORTH 1500 WEST
OREM, UT 84057